

# RS II VSTD



## Packed full of performance and technology

- ➔ **TWO POWER LEVELS NOW AVAILABLE**
- ➔ Energy saving: **up to 85%\* on electricity consumption**
- ➔ **Appreciable acoustic comfort** during low-speed operating phases
- ➔ **Simple and intuitive digital interface**
- ➔ **4 digital inputs** allow the pump to be operated by an external controller
- ➔ **180° rotatable box for convenient access** to the user interface
- ➔ **New connection box for easier electrical connection**
- ➔ **Quarter-turn opening cover** for easy maintenance
- ➔ **Secure butterfly valve cover** for easy maintenance
- ➔ **Union fittings provided** to ensure ease of installation

\* Energy savings of at least 65% are generally achieved.

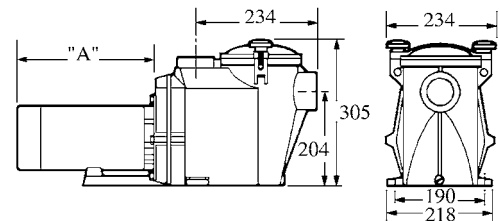

Intuitive display of relevant information such as real-time energy consumption. Possibility of five daily programmes. Skimming function to skim the surface automatically every 1, 2 or 3 hours. **Timer mode.**

### ➔ 2 HP Curve

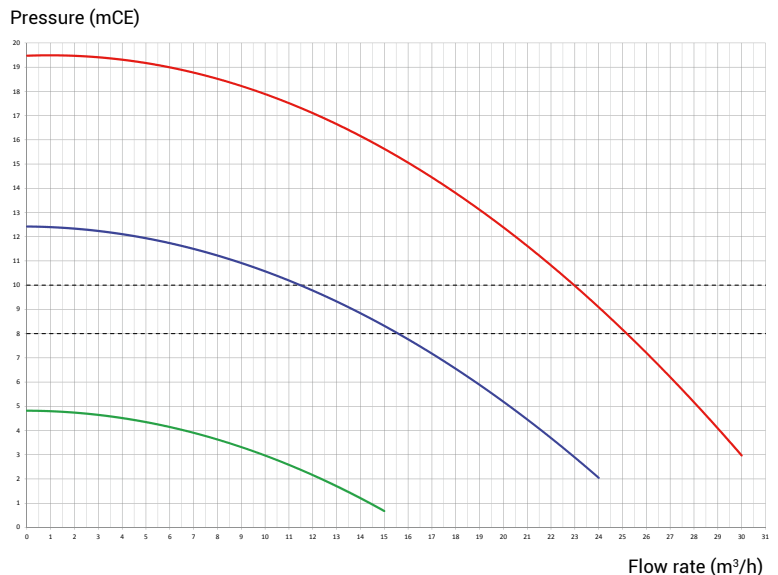

### ➔ 1.5 HP Curve

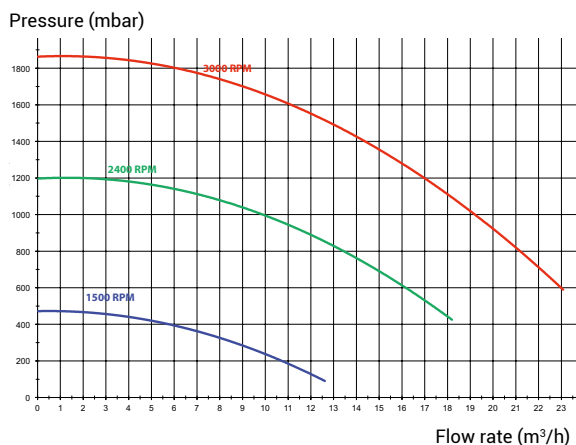

RS II VSTD

Speed	Type	Water flow rate*	In/Out	Input Power P1	Power output P2	Amperage*	Item
600 - 3000 RPM (20 rpm)	1.5 HP	@10 m: 21 m³/h @8 m: 19 m³/h	63 mm	1 340 W	1 100 W	@10 m: 5.63 @8 m: 5.66	RS3016VSTD
600 - 3000 RPM (20 rpm)	2 HP	@10 m: 23 m³/h @8 m: 25 m³/h	63 mm	@10 m: 1 509 W @8 m: 1 544 W	@10 m: 1 400 W @8 m: 1 400 W	@10 m: 6.3 @8 m: 6.5	RS3020VSTD

\* at 3000 Rpm